

Architects:  
**Kiss + Cathcart, Architects**  
 44 Court Street, Tower C  
 Brooklyn, NY 11201  
 (718) 237-2786 phone / (718) 237-2025 fax

MEP Engineers:  
**Goldman Copeland Associates**  
 520 Eighth Avenue  
 New York, NY 10018  
 (212) 868-4660 phone / (212) 868-4680 fax

Structural Engineers:  
**Robert Silman Associates**  
 88 University Place  
 New York, NY 10003  
 (212) 620-7970 phone / (212) 620-8157 fax

Landscape:  
**Donna Walcavage Landscape and Urban Design**  
 212 Hicks Street  
 Brooklyn, NY 11201  
 (718) 834-0224 phone / (718) 834-9102 fax

Lighting:  
**AWA Architectural Lighting Designers**  
 504 LaGuardia Place, 5th Floor  
 New York, NY 10012  
 (212) 473-9797 phone / (212) 473-9708 fax

| No. | Date     | Revisions / Submissions              |
|-----|----------|--------------------------------------|
| 1   | 03/26/09 | COORDINATION/CLARIFICATION           |
| 2   | 07/18/08 | VAPOR MITIGATION SYSTEM              |
| 3   | 03/21/08 | REVISION PER CELLAR ELEVATION CHANGE |
| 4   | 04/02/07 | COORDINATION/CLARIFICATION           |
| 5   | 12/06/06 | CONTRACT DOCUMENT                    |
| 6   | 11/17/06 | BID ADDENDUM                         |
| 7   | 10/06/06 | BID ADDENDUM                         |
| 8   | 09/18/06 | BID DOCUMENT 100%                    |
| 9   | 08/21/06 | CONSTRUCTION DOCUMENT 100%           |

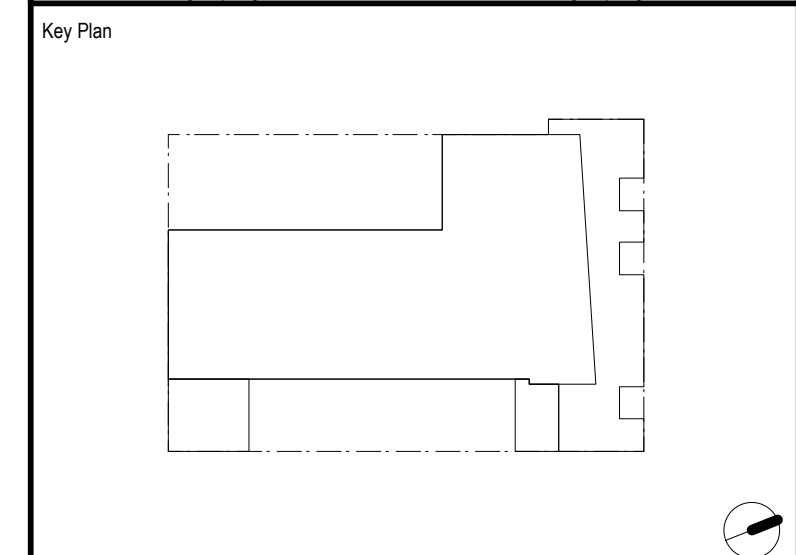
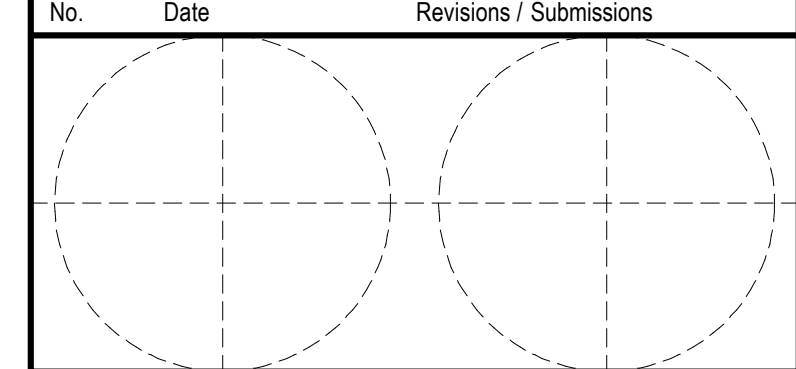

Project Title  
**The Pitt Street Residence  
 Common Ground Community**  
 133 Pitt Street  
 New York, NY  
 10002

Drawing Title  
**Exterior Elevations  
 North and South**

Date: 09/18/06  
 Scale: 1/8" = 1'-0"

Drawn By: SA  
 Drawing No.: **A-202**

Reviewed By: CC