

NO.	DATE	DESCRIPTION	ISSUED TO	NO.	DATE	PKG. NO.
A	1-11-71	GENERAL REVISIONS				
B	3-16-72	ADDED GIL PUMP ENCLOSED AT GARAGE				
C	6-17-72	ADDED DIMENSIONS IN KITCHEN REVISED TO 11'-0" WIDE REVISION 1				
D	7-14-72	REVISION 2 - WALL IN KITCHEN REVISION 3 - WALL IN KITCHEN IN THIS AREA TO BE REMOVED AND NEW WALL TO BE PLACED AS SHOWN ON DRAWING REVISION 4 - REVISION 5 - REVISION 6 - REVISION 7 - REVISION 8 - REVISION 9 - REVISION 10 - REVISION 11 - REVISION 12 - REVISION 13 - REVISION 14 - REVISION 15 - REVISION 16 - REVISION 17 - REVISION 18 - REVISION 19 - REVISION 20 - REVISION 21 - REVISION 22 - REVISION 23 - REVISION 24 - REVISION 25 -				
E	4-12-73					
F	7-2-73					
G	7-2-73					
H	7-2-73					
I	7-2-73					
J	7-2-73					
K	7-2-73					
L	7-2-73					
M	7-2-73					
N	7-2-73					
O	7-2-73					
P	7-2-73					
Q	7-2-73					
R	7-2-73					
S	7-2-73					
T	7-2-73					
U	7-2-73					
V	7-2-73					
W	7-2-73					
X	7-2-73					
Y	7-2-73					
Z	7-2-73					

**BANKERS TRUST
PLAZA**
**A FISHER BROTHERS
PROJECT**
GREENWICH AND LIBERTY ST. N. Y. N. Y.
SHREVE, LAMB & HARMON ASSOCIATES P.C.
ARCHITECTS
475 PARK AVENUE SOUTH N. Y. N. Y. 10016
PETERSON AND BRICKBAUER
ASSOCIATED ARCHITECTS
919 THIRD AVENUE N. Y. N. Y. 10022
THE OFFICE OF JAMES RUDERMAN
THE STRUCTURAL ENGINEERS
315 MADISON AVENUE N. Y. N. Y. 10022
JAMES BAUM & BOLLES
MECH. & ELEC. ENGINEERS
345 PARK AVENUE N. Y. N. Y. 10022

4 THE PLAY CONSTRUCTION
(7TH TENANT)

PROJECT NUMBER	7101
DRAWING NUMBER	A 14
DATE	7-1-73
SCALE	1/8" = 1'-0"

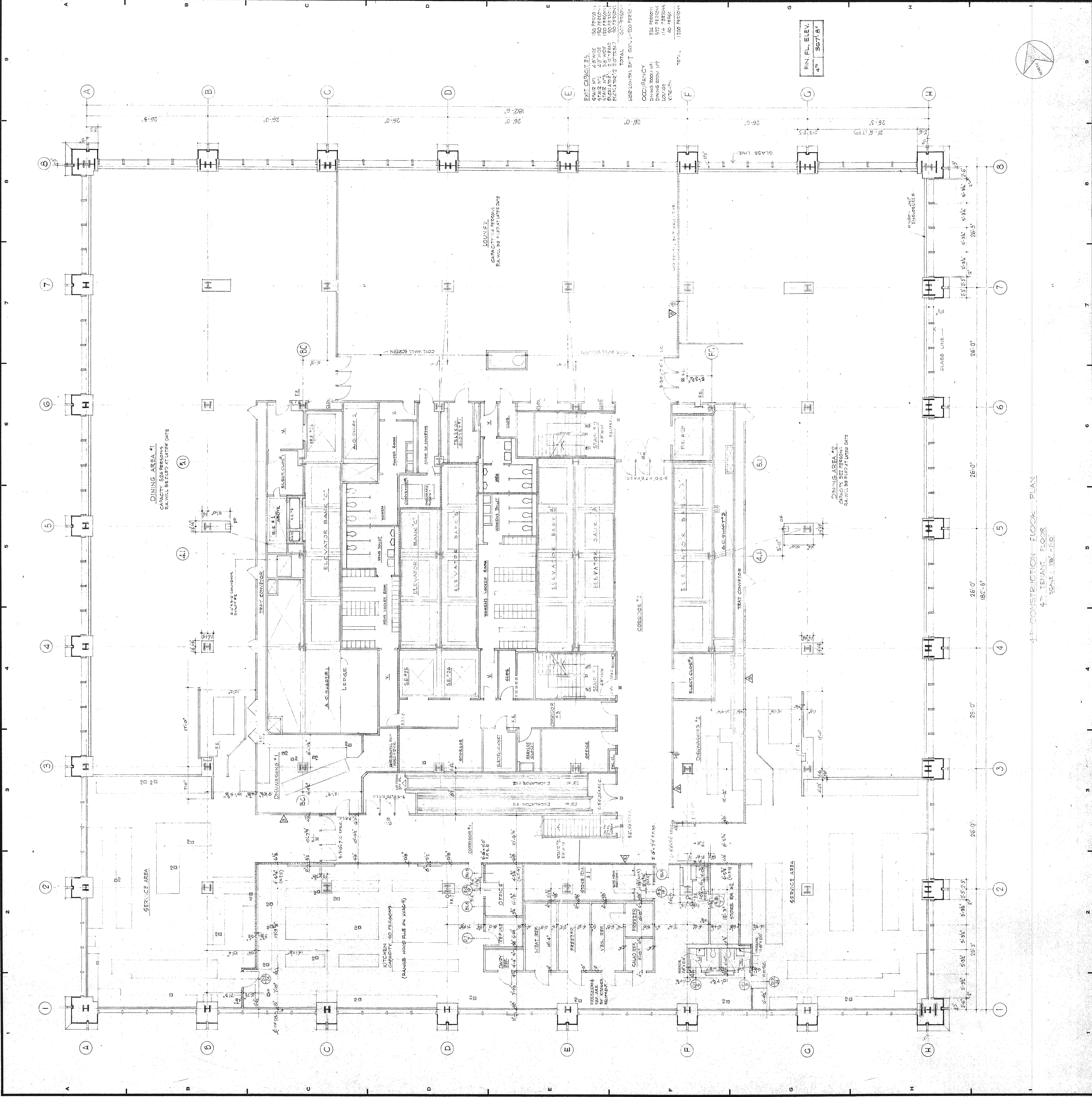

4th CONSTRUCTION FLOOR PLAN
4th TENANT FLOOR
SCALE 1/8" = 1'-0"