

REVISIONS	
NO.	DESCRIPTION
A	11-15-71
B	1-15-72
C	7-24-72
D	9-13-72
E	4-12-73

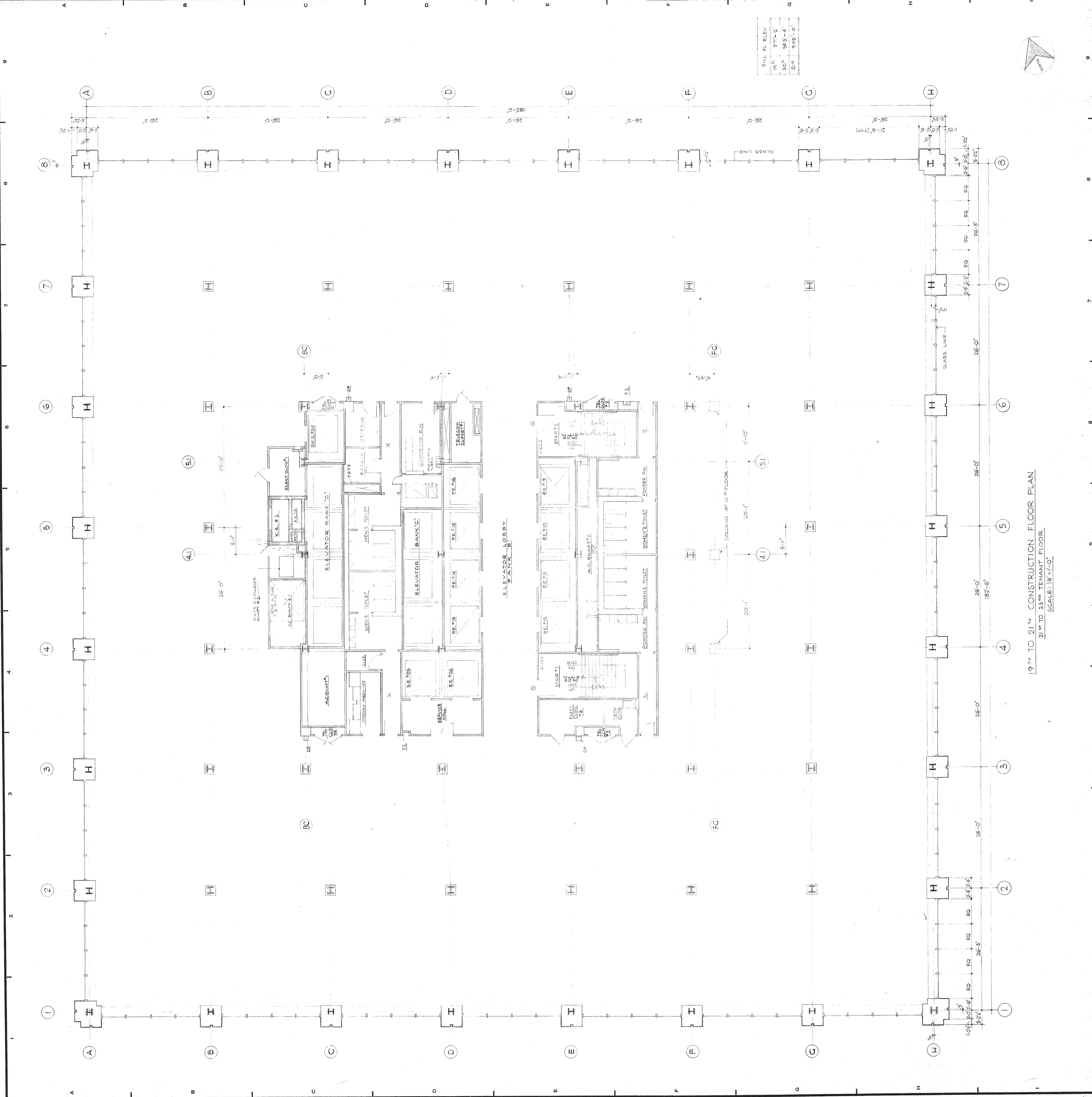

19" TO 21" CONSTRUCTION FLOOR PLAN  
21 TO 23" TENANT FLOOR  
SCALE: 1/8" = 1'-0"

ISSUED TO	NO.	DATE	PKG. NO.
1	1	1-15-73	PC 26211
2	2	7-26-73	PC 26847
3	3	4-11-72	PC 26137
4	4	4-12-73	PC 26115
5	5	7-7-73	PC 26115
6	6	4-12-73	PC 26115
7	7	7-26-73	PC 26847
8	8	4-11-72	PC 26137
9	9	4-12-73	PC 26115
10	10	4-12-73	PC 26115
11	11	7-26-73	PC 26847
12	12	1-15-73	PC 26211

**BANKERS TRUST  
PLAZA**

**A FISHER BROTHERS  
PROJECT**

GREENWICH AND LIBERTY ST. N. Y. N. Y.

SHREVE, LAMB & HARMON ASSOCIATES P.C.  
ARCHITECTS  
475 PARK AVENUE SOUTH N. Y. N. Y. 10016

PETERSON AND BRICKBAUER  
ASSOCIATED ARCHITECTS  
919 THIRD AVENUE N. Y. N. Y. 10022

THE OFFICE OF JAMES RUDERMAN  
STRUCTURAL ENGINEERS  
315 MADISON AVENUE N. Y. N. Y. 10022

JAROS, BAUM & BOLLES  
MECH.&ELEC. ENGINEERS  
345 PARK AVENUE N. Y. N. Y. 10022

19" TO 21" FLOOR PLANS CONSTRUCTION  
(21" TO 23" TENANT)

PROJECT NUMBER  
**7101**

DRAWING NUMBER  
**A19**

DATE  
11-15-71

SCALE  
1/8" = 1'-0"

FIN. FL. ELEV.
19" 87'-0"
20" 88'-0"
21" 89'-0"
22" 90'-0"