

R E V I S I O N S		
NO.	DATE	DESCRIPTION
A	11-11-71	GENERAL REVISIONS
B	2-16-72	WORK ON PIPE ENCLASURES AT COL. 41 & 42
C	7-24-72	REMOVED 1" DIA. & 4" DIA. PIPES FROM START
D	7-13-72	REMOVED 1" DIA. & 4" DIA. PIPES FROM START
E	4-18-72	REMOVED 1" DIA. & 4" DIA. PIPES FROM START

ISSUED TO	NO.	DATE	PAGE NO.
GREENWICH	1	12-1-71	92
GREENWICH	2	4-4-72	92
GREENWICH	3	1-21-74	92
GREENWICH	4	11-14-75	92
GREENWICH	5	7-7-75	92
GREENWICH	6	4-11-77	92
GREENWICH	7	4-12-77	92
GREENWICH	8	4-12-77	92
GREENWICH	9	8-14-73	92
GREENWICH	10	12-19-72	92
GREENWICH	11	10-17-72	92
GREENWICH	12	10-15-72	92
GREENWICH	13	10-15-72	92
GREENWICH	14	10-15-72	92
GREENWICH	15	10-15-72	92
GREENWICH	16	10-15-72	92
GREENWICH	17	10-15-72	92
GREENWICH	18	10-15-72	92
GREENWICH	19	10-15-72	92
GREENWICH	20	10-15-72	92
GREENWICH	21	10-15-72	92
GREENWICH	22	10-15-72	92
GREENWICH	23	10-15-72	92
GREENWICH	24	10-15-72	92
GREENWICH	25	10-15-72	92
GREENWICH	26	10-15-72	92
GREENWICH	27	10-15-72	92
GREENWICH	28	10-15-72	92
GREENWICH	29	10-15-72	92
GREENWICH	30	10-15-72	92
GREENWICH	31	10-15-72	92
GREENWICH	32	10-15-72	92
GREENWICH	33	10-15-72	92
GREENWICH	34	10-15-72	92
GREENWICH	35	10-15-72	92
GREENWICH	36	10-15-72	92
GREENWICH	37	10-15-72	92
GREENWICH	38	10-15-72	92
GREENWICH	39	10-15-72	92
GREENWICH	40	10-15-72	92
GREENWICH	41	10-15-72	92
GREENWICH	42	10-15-72	92
GREENWICH	43	10-15-72	92
GREENWICH	44	10-15-72	92
GREENWICH	45	10-15-72	92
GREENWICH	46	10-15-72	92
GREENWICH	47	10-15-72	92
GREENWICH	48	10-15-72	92
GREENWICH	49	10-15-72	92
GREENWICH	50	10-15-72	92
GREENWICH	51	10-15-72	92
GREENWICH	52	10-15-72	92
GREENWICH	53	10-15-72	92
GREENWICH	54	10-15-72	92
GREENWICH	55	10-15-72	92
GREENWICH	56	10-15-72	92
GREENWICH	57	10-15-72	92
GREENWICH	58	10-15-72	92
GREENWICH	59	10-15-72	92
GREENWICH	60	10-15-72	92
GREENWICH	61	10-15-72	92
GREENWICH	62	10-15-72	92
GREENWICH	63	10-15-72	92
GREENWICH	64	10-15-72	92
GREENWICH	65	10-15-72	92
GREENWICH	66	10-15-72	92
GREENWICH	67	10-15-72	92
GREENWICH	68	10-15-72	92
GREENWICH	69	10-15-72	92
GREENWICH	70	10-15-72	92
GREENWICH	71	10-15-72	92
GREENWICH	72	10-15-72	92
GREENWICH	73	10-15-72	92
GREENWICH	74	10-15-72	92
GREENWICH	75	10-15-72	92
GREENWICH	76	10-15-72	92
GREENWICH	77	10-15-72	92
GREENWICH	78	10-15-72	92
GREENWICH	79	10-15-72	92
GREENWICH	80	10-15-72	92
GREENWICH	81	10-15-72	92
GREENWICH	82	10-15-72	92
GREENWICH	83	10-15-72	92
GREENWICH	84	10-15-72	92
GREENWICH	85	10-15-72	92
GREENWICH	86	10-15-72	92
GREENWICH	87	10-15-72	92
GREENWICH	88	10-15-72	92
GREENWICH	89	10-15-72	92
GREENWICH	90	10-15-72	92
GREENWICH	91	10-15-72	92
GREENWICH	92	10-15-72	92
GREENWICH	93	10-15-72	92
GREENWICH	94	10-15-72	92
GREENWICH	95	10-15-72	92
GREENWICH	96	10-15-72	92
GREENWICH	97	10-15-72	92
GREENWICH	98	10-15-72	92
GREENWICH	99	10-15-72	92
GREENWICH	100	10-15-72	92

**BANKERS TRUST
PLAZA**

**A FISHER BROTHERS
PROJECT**

GREENWICH AND LIBERTY ST. N. Y. N. Y.
SHREVE, LAMB & HARMON ASSOCIATES P.C.
ARCHITECTS
475 PARK AVENUE SOUTH N. Y. N. Y. 10016
PETERSON AND BRICKBAUER
ASSOCIATED ARCHITECTS
919 THIRD AVENUE N. Y. N. Y. 10022
THE OFFICE OF JAMES RUDERMAN
STRUCTURAL ENGINEERS
15 MADISON AVENUE N. Y. N. Y. 10022
J. A. ROS, BAUM & BOLLES
MECH. & ELEC. ENGINEERS
345 PARK AVENUE N. Y. N. Y. 10022

29TH FLOOR CONSTRUCTION
(SUIT TENANT)

PROJECT NUMBER
7101

DRAWING NUMBER
A22

DATE SEP 11 1971
SCALE 1/8" = 1'-0"

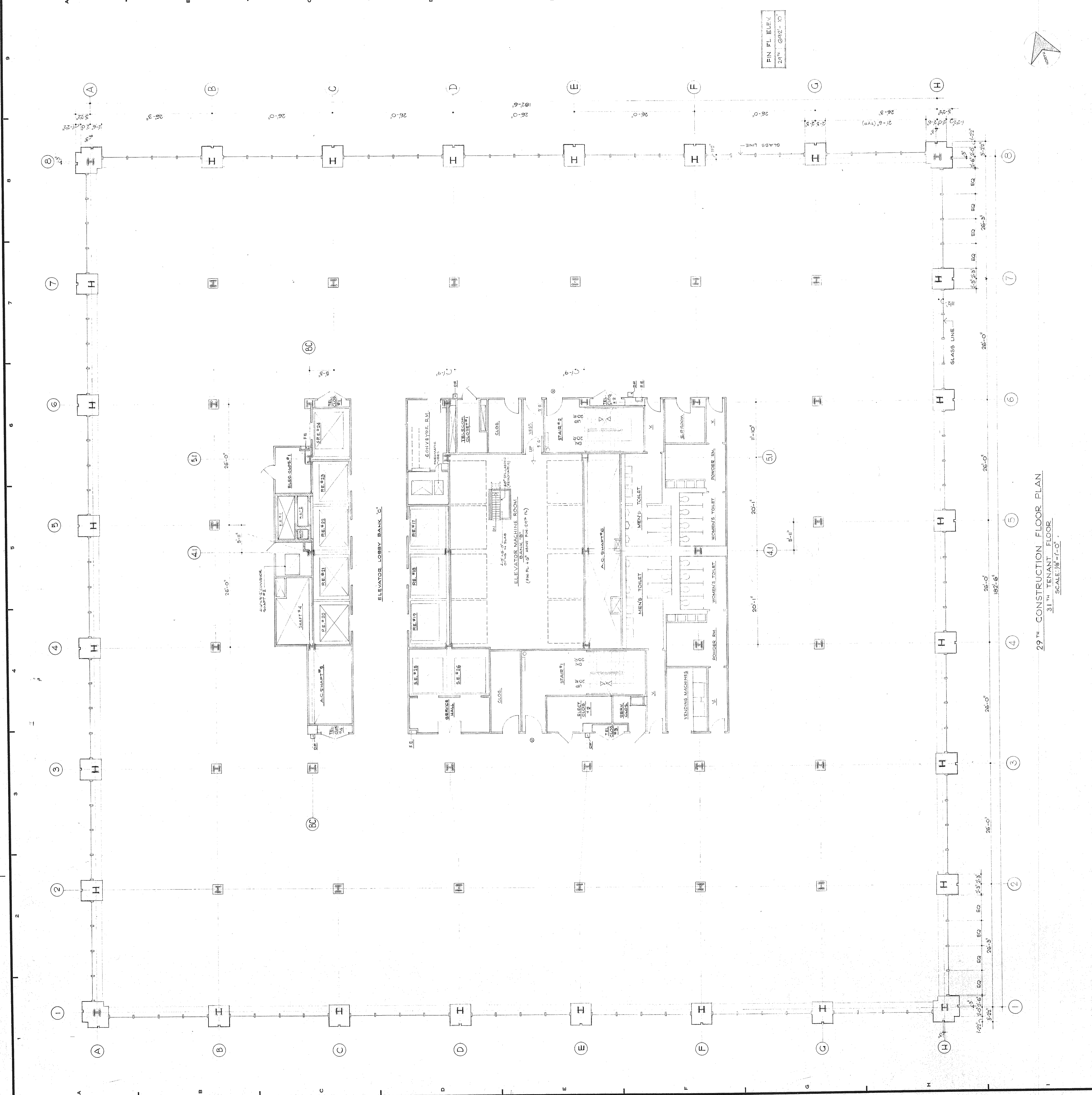

29TH CONSTRUCTION FLOOR PLAN
31TH TENANT FLOOR
SCALE 1/8" = 1'-0"