

REVISIONS		
NO.	DATE	DESCRIPTION
A	1-11-71	GENERAL REVISIONS
B	3-16-72	APPROD. OIL PIPE ENCLOSURE AT COL. 18C
C	7-24-72	QUANTIFIED PANEL ASSIGNED CONCRETE UNIT, 20' X 10' X 12' 6" WITH 1/2" REINFORCING BARS. 20' X 10' X 12' 6" WITH 1/2" REINFORCING BARS. 20' X 10' X 12' 6" WITH 1/2" REINFORCING BARS.
E	4-12-72	STARTED CORRAL SCAFFOLDING IN REAR COURTS
F		AS PER 10/22/72 CORRAL # 10/22/72 AT

ISSUED TO	NO.	DATE	PKG. NO.
F/W	2	2-24-74	PC 242215
F/W	4	1-24-74	PC 242115
F/W	1	11-14-73	PC 216681
F/W	6	5-7-73	PC 24191
F/W	24	3-11-73	PC 242141
F/W	27	4-12-73	PC 24115
F/W	1	3-14-74	PC 24215
F/W	10	2-19-73	PC 24212
F/W	19	11-19-72	PC 19215
F/W	23	11-17-72	PC 24210
F/W	26	10-26-72	PC 24212

**BANKERS TRUST
PLAZA**

**A FISHER BROTHERS
PROJECT**

GREENWICH AND LIBERTY ST. N. Y. N. Y.

SHREVE, LAMB & HARMON ASSOCIATES PC
ARCHITECTS
475 PARK AVENUE SOUTH N. Y. N. Y. 10016

PETERSON AND BRICKBAUER
ASSOCIATED ARCHITECTS
919 THIRD AVENUE N. Y. N. Y. 10022

THE OFFICE OF JAMES RUDERMAN
STRUCTURAL ENGINEERS
315 MADISON AVENUE N. Y. N. Y. 10022

JAROS, BAUM & BOLLE S
MECH & ELEC. ENGINEERS
345 PARK AVENUE N. Y. N. Y. 10022

30TH FLOOR PLAN-CONSTRUCTION
(2ND TENANT)

PROJECT NUMBER
7101

DRAWING NUMBER
A 23

DATE SEP 2 1971
SCALE 1/8" = 1'-0"

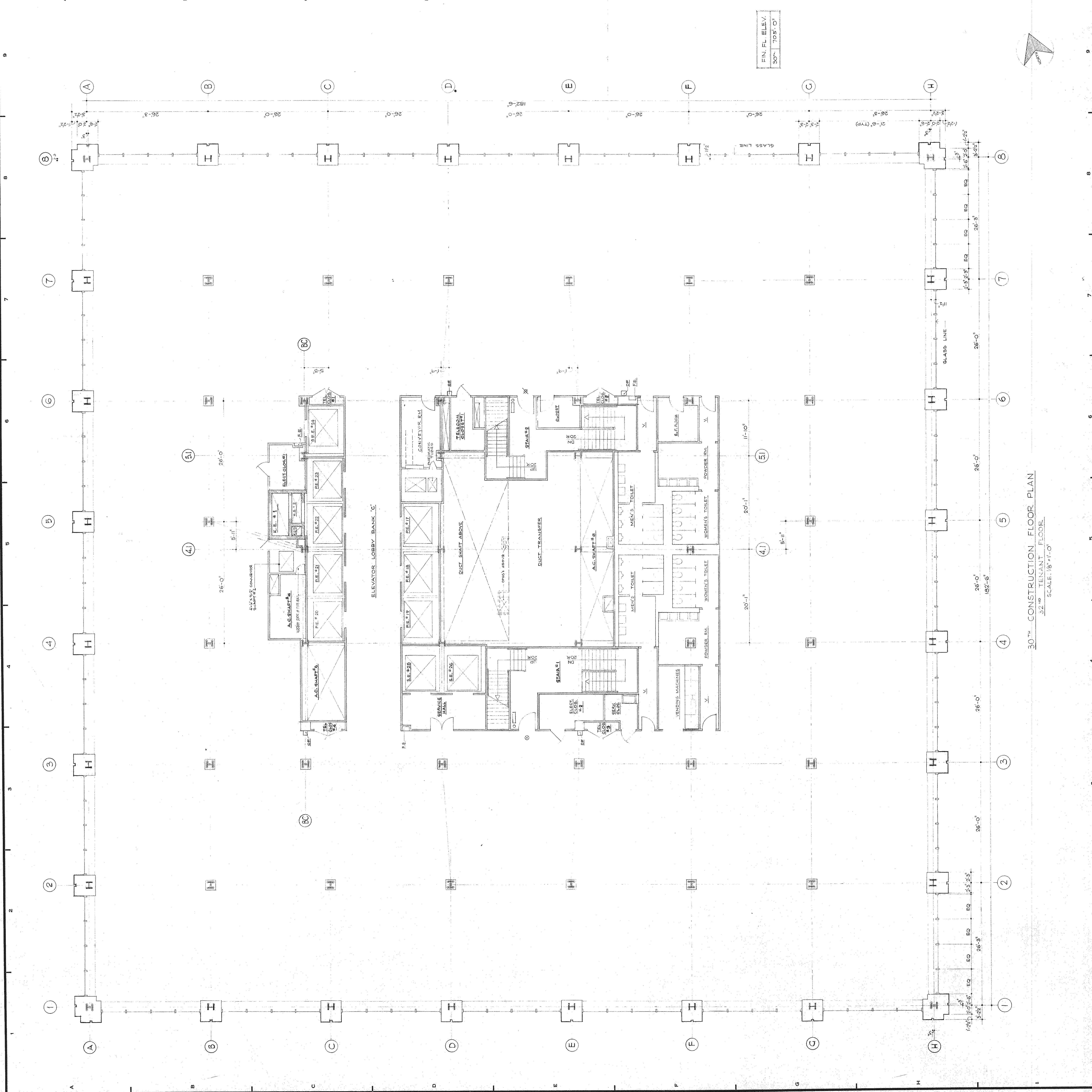

30TH CONSTRUCTION FLOOR PLAN
TENANT FLOOR
SCALE: 1/8" = 1'-0"