

| REVISIONS | | |
|-----------|----------|---|
| NO. | DATE | DESCRIPTION |
| A | 11-11-71 | CONTRACT REVISIONS |
| B | 2-15-72 | ADDED PIPE ENCLOSURES AT COL-1, 2, 3 |
| C | 3-14-72 | ADDED SECTION IN BUILT-UP, ADDED REVISIONAL ELEV. INDICATIONS |
| D | 7-24-72 | ADDED 2" MIN. LAMINATED GLASS BY ELEVATOR |
| E | 9-12-72 | ADDED 2" MIN. LAMINATED GLASS BY ELEVATOR |
| F | 12-12-72 | ADDED 2" MIN. LAMINATED GLASS BY ELEVATOR |
| G | 1-4-73 | REV. ENCLOSURE TO COL-4, 5, 6, 7, 8, 9, 10, 11, 12, 13, 14, 15, 16, 17, 18, 19, 20, 21, 22, 23, 24, 25, 26, 27, 28, 29, 30, 31, 32, 33, 34, 35, 36, 37, 38, 39, 40, 41, 42, 43, 44, 45, 46, 47, 48, 49, 50, 51, 52, 53, 54, 55, 56, 57, 58, 59, 60, 61, 62, 63, 64, 65, 66, 67, 68, 69, 70, 71, 72, 73, 74, 75, 76, 77, 78, 79, 80, 81, 82, 83, 84, 85, 86, 87, 88, 89, 90, 91, 92, 93, 94, 95, 96, 97, 98, 99, 100 |
| H | 1-15-74 | ADDED 2" MIN. LAMINATED GLASS BY ELEVATOR |

| ISSUED TO | NO. | DATE | PKG. NO. |
|-----------|-----|---------|----------|
| 1 | 1 | 0-18-71 | 1A, 3113 |
| 2 | 2 | 7-24-72 | 2C, 3143 |
| 3 | 3 | 7-24-72 | 2C, 3143 |
| 4 | 4 | 7-24-72 | 2C, 3143 |
| 5 | 5 | 7-24-72 | 2C, 3143 |
| 6 | 6 | 7-24-72 | 2C, 3143 |
| 7 | 7 | 7-24-72 | 2C, 3143 |
| 8 | 8 | 7-24-72 | 2C, 3143 |
| 9 | 9 | 7-24-72 | 2C, 3143 |
| 10 | 10 | 7-24-72 | 2C, 3143 |
| 11 | 11 | 7-24-72 | 2C, 3143 |
| 12 | 12 | 7-24-72 | 2C, 3143 |
| 13 | 13 | 7-24-72 | 2C, 3143 |
| 14 | 14 | 7-24-72 | 2C, 3143 |
| 15 | 15 | 7-24-72 | 2C, 3143 |
| 16 | 16 | 7-24-72 | 2C, 3143 |
| 17 | 17 | 7-24-72 | 2C, 3143 |
| 18 | 18 | 7-24-72 | 2C, 3143 |
| 19 | 19 | 7-24-72 | 2C, 3143 |
| 20 | 20 | 7-24-72 | 2C, 3143 |
| 21 | 21 | 7-24-72 | 2C, 3143 |
| 22 | 22 | 7-24-72 | 2C, 3143 |
| 23 | 23 | 7-24-72 | 2C, 3143 |
| 24 | 24 | 7-24-72 | 2C, 3143 |
| 25 | 25 | 7-24-72 | 2C, 3143 |
| 26 | 26 | 7-24-72 | 2C, 3143 |
| 27 | 27 | 7-24-72 | 2C, 3143 |
| 28 | 28 | 7-24-72 | 2C, 3143 |
| 29 | 29 | 7-24-72 | 2C, 3143 |
| 30 | 30 | 7-24-72 | 2C, 3143 |
| 31 | 31 | 7-24-72 | 2C, 3143 |
| 32 | 32 | 7-24-72 | 2C, 3143 |
| 33 | 33 | 7-24-72 | 2C, 3143 |
| 34 | 34 | 7-24-72 | 2C, 3143 |
| 35 | 35 | 7-24-72 | 2C, 3143 |
| 36 | 36 | 7-24-72 | 2C, 3143 |
| 37 | 37 | 7-24-72 | 2C, 3143 |
| 38 | 38 | 7-24-72 | 2C, 3143 |
| 39 | 39 | 7-24-72 | 2C, 3143 |
| 40 | 40 | 7-24-72 | 2C, 3143 |
| 41 | 41 | 7-24-72 | 2C, 3143 |
| 42 | 42 | 7-24-72 | 2C, 3143 |
| 43 | 43 | 7-24-72 | 2C, 3143 |
| 44 | 44 | 7-24-72 | 2C, 3143 |
| 45 | 45 | 7-24-72 | 2C, 3143 |
| 46 | 46 | 7-24-72 | 2C, 3143 |
| 47 | 47 | 7-24-72 | 2C, 3143 |
| 48 | 48 | 7-24-72 | 2C, 3143 |
| 49 | 49 | 7-24-72 | 2C, 3143 |
| 50 | 50 | 7-24-72 | 2C, 3143 |
| 51 | 51 | 7-24-72 | 2C, 3143 |
| 52 | 52 | 7-24-72 | 2C, 3143 |
| 53 | 53 | 7-24-72 | 2C, 3143 |
| 54 | 54 | 7-24-72 | 2C, 3143 |
| 55 | 55 | 7-24-72 | 2C, 3143 |
| 56 | 56 | 7-24-72 | 2C, 3143 |
| 57 | 57 | 7-24-72 | 2C, 3143 |
| 58 | 58 | 7-24-72 | 2C, 3143 |
| 59 | 59 | 7-24-72 | 2C, 3143 |
| 60 | 60 | 7-24-72 | 2C, 3143 |
| 61 | 61 | 7-24-72 | 2C, 3143 |
| 62 | 62 | 7-24-72 | 2C, 3143 |
| 63 | 63 | 7-24-72 | 2C, 3143 |
| 64 | 64 | 7-24-72 | 2C, 3143 |
| 65 | 65 | 7-24-72 | 2C, 3143 |
| 66 | 66 | 7-24-72 | 2C, 3143 |
| 67 | 67 | 7-24-72 | 2C, 3143 |
| 68 | 68 | 7-24-72 | 2C, 3143 |
| 69 | 69 | 7-24-72 | 2C, 3143 |
| 70 | 70 | 7-24-72 | 2C, 3143 |
| 71 | 71 | 7-24-72 | 2C, 3143 |
| 72 | 72 | 7-24-72 | 2C, 3143 |
| 73 | 73 | 7-24-72 | 2C, 3143 |
| 74 | 74 | 7-24-72 | 2C, 3143 |
| 75 | 75 | 7-24-72 | 2C, 3143 |
| 76 | 76 | 7-24-72 | 2C, 3143 |
| 77 | 77 | 7-24-72 | 2C, 3143 |
| 78 | 78 | 7-24-72 | 2C, 3143 |
| 79 | 79 | 7-24-72 | 2C, 3143 |
| 80 | 80 | 7-24-72 | 2C, 3143 |
| 81 | 81 | 7-24-72 | 2C, 3143 |
| 82 | 82 | 7-24-72 | 2C, 3143 |
| 83 | 83 | 7-24-72 | 2C, 3143 |
| 84 | 84 | 7-24-72 | 2C, 3143 |
| 85 | 85 | 7-24-72 | 2C, 3143 |
| 86 | 86 | 7-24-72 | 2C, 3143 |
| 87 | 87 | 7-24-72 | 2C, 3143 |
| 88 | 88 | 7-24-72 | 2C, 3143 |
| 89 | 89 | 7-24-72 | 2C, 3143 |
| 90 | 90 | 7-24-72 | 2C, 3143 |
| 91 | 91 | 7-24-72 | 2C, 3143 |
| 92 | 92 | 7-24-72 | 2C, 3143 |
| 93 | 93 | 7-24-72 | 2C, 3143 |
| 94 | 94 | 7-24-72 | 2C, 3143 |
| 95 | 95 | 7-24-72 | 2C, 3143 |
| 96 | 96 | 7-24-72 | 2C, 3143 |
| 97 | 97 | 7-24-72 | 2C, 3143 |
| 98 | 98 | 7-24-72 | 2C, 3143 |
| 99 | 99 | 7-24-72 | 2C, 3143 |
| 100 | 100 | 7-24-72 | 2C, 3143 |

BANKERS TRUST PLAZA

A FISHER BROTHERS PROJECT

GREENWICH AND LIBERTY ST. N. Y. N. Y.

SHREVE, LAMB & HARMON ASSOCIATES PC ARCHITECTS
475 PARK AVENUE SOUTH N. Y. N. Y. 10016

PETERSON AND BRICKBAUER ASSOCIATED ARCHITECTS
919 THIRD AVENUE N. Y. N. Y. 10022

THE OFFICE OF JAMES RUDERMAN STRUCTURAL ENGINEERS
315 MADISON AVENUE N. Y. N. Y. 10022

JAROS, BAUM & BOLLES MECH. & ELEC. ENGINEERS
345 PARK AVENUE N. Y. N. Y. 10022

| FIN. FL. ELEV. | OFFICE AP. 1 | COMPL. 1976 |
|----------------|--------------|-------------|
| 85'-0" | 7281-4 | 7951-4 |
| 93'-0" | 7211-4 | 7942-4 |
| 94'-0" | 754-A-B | 754-B |
| 95'-0" | 767-10 | 765-10 |
| 96'-0" | 781-9 | 783-9 |
| 97'-0" | 796C-2 | 797-8 |

32ND TO 37TH FL. PLANS-CONSTRUCTION

(34TH TO 37TH TENANT)

PROJECT NUMBER 7101

DRAWING NUMBER **A25**

DATE 12/15/71

SCALE 1/8"=1'-0"

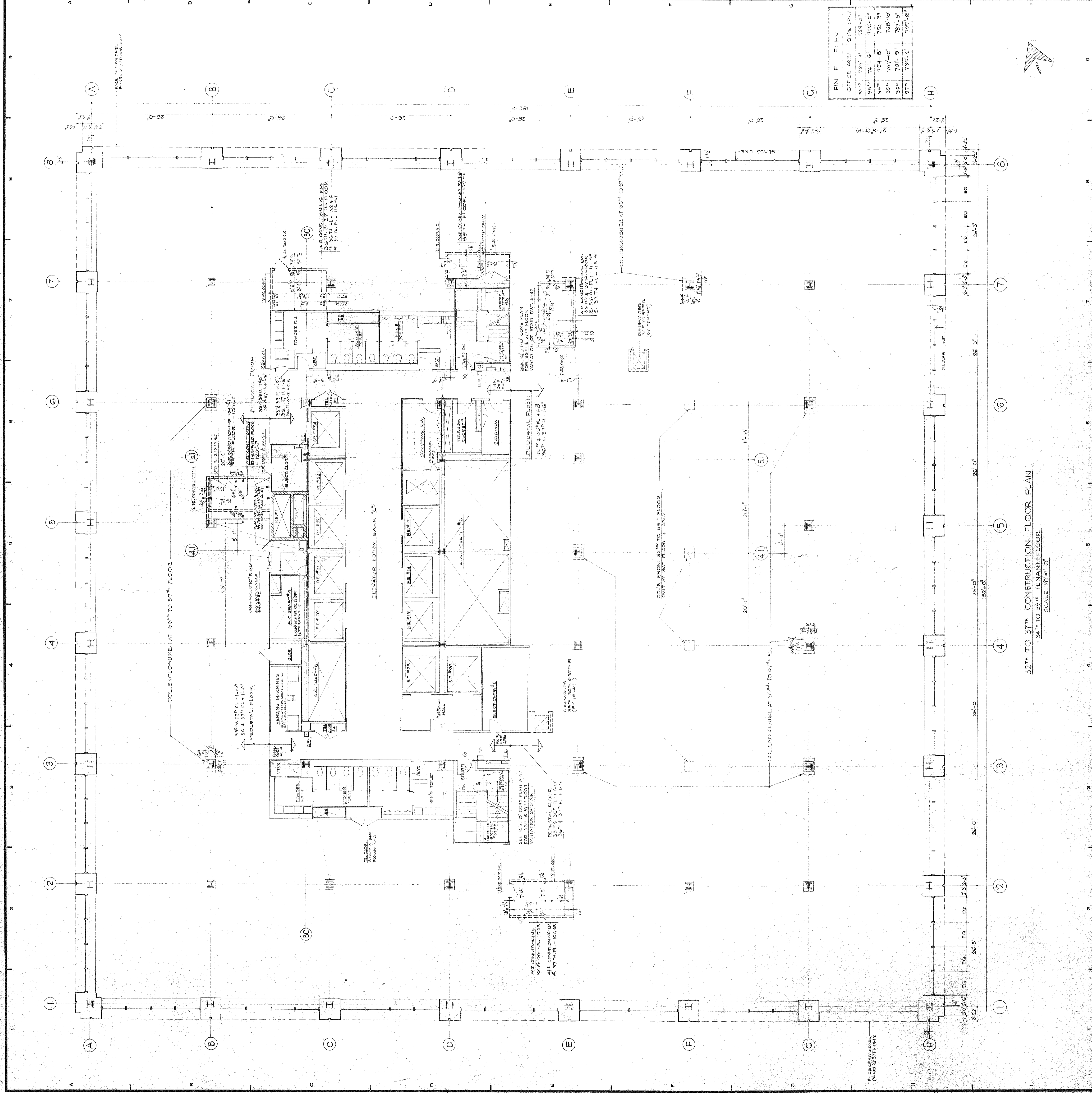

32ND TO 37TH CONSTRUCTION FLOOR PLAN
34TH TO 37TH TENANT FLOOR
SCALE: 1/8"=1'-0"