

REVISIONS	
NO.	DESCRIPTION
A	REVISED TO SHOW... ADD STAIRS... CORRECT... REVISED... ADD... REVISOR... DATE... DRAWN... CHECKED... APPROVED... PROJECT... DATE... SCALE...
B	REVISED... CORRECT... REVISED... ADD... REVISOR... DATE... DRAWN... CHECKED... APPROVED... PROJECT... DATE... SCALE...
C	REVISED... CORRECT... REVISED... ADD... REVISOR... DATE... DRAWN... CHECKED... APPROVED... PROJECT... DATE... SCALE...
D	REVISED... CORRECT... REVISED... ADD... REVISOR... DATE... DRAWN... CHECKED... APPROVED... PROJECT... DATE... SCALE...
E	REVISED... CORRECT... REVISED... ADD... REVISOR... DATE... DRAWN... CHECKED... APPROVED... PROJECT... DATE... SCALE...

ISSUED TO	NO.	DATE	PKG. NO.
...
...
...
...
...
...
...
...
...
...
...
...
...
...
...
...
...
...
...
...
...
...
...
...
...

BANKERS TRUST PLAZA

A FISHER BROTHERS PROJECT

GREENWICH AND LIBERTY ST. N. Y. N. Y.

SHRIVE LAMB & HARMON ASSOCIATES P.C.

ARCHITECTS

475 PARK AVENUE SOUTH N. Y. N. Y. 10016

PETERSON AND BRICKBAUER ASSOCIATED ARCHITECTS

919 THIRD AVENUE N. Y. N. Y. 10022

THE OFFICE OF JAMES RUDERMAN STRUCTURAL ENGINEERS

315 MADISON AVENUE N. Y. N. Y. 10022

J. A. ROS. BAUM & BOLLE'S MECH. & ELEC. ENGINEERS

345 PARK AVENUE N. Y. N. Y. 10022

CELLAR CORE PLAN	LEVEL A
PROJECT NUMBER	7101
DRAWING NUMBER	A 32
DATE	...
SCALE	1/4" = 1'-0"

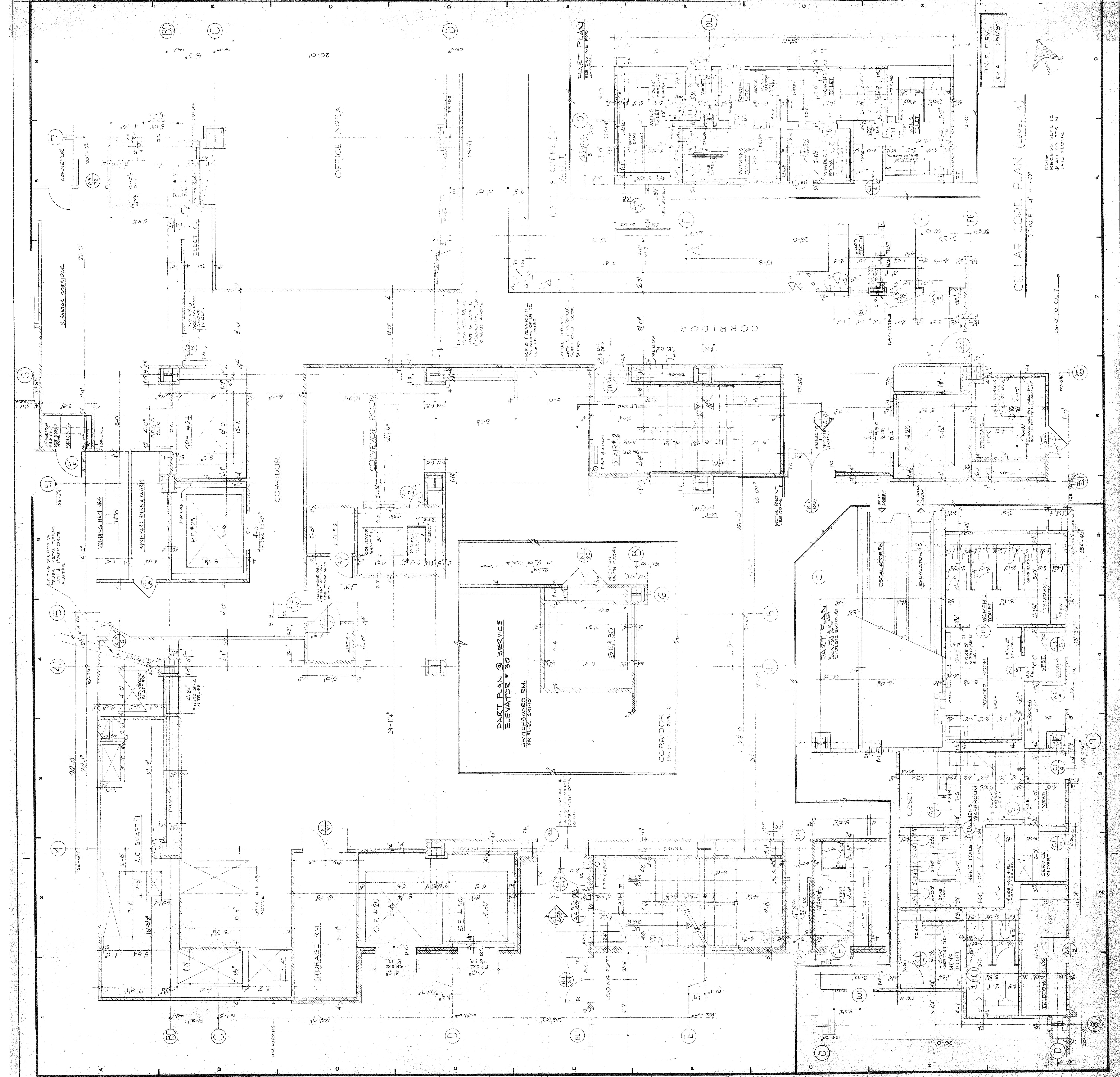

CELLAR CORE PLAN (LEVEL A)

SCALE: 1/4" = 1'-0"

NOTE: ACCESS SHALL BE THROUGH THIS FLOOR.

CELLAR CORE PLAN
LEVEL A

PROJECT NUMBER
7101

DRAWING NUMBER
A 32

DATE
...

SCALE
1/4" = 1'-0"

Handwritten signature: Henry B. Clark
Handwritten text: President